

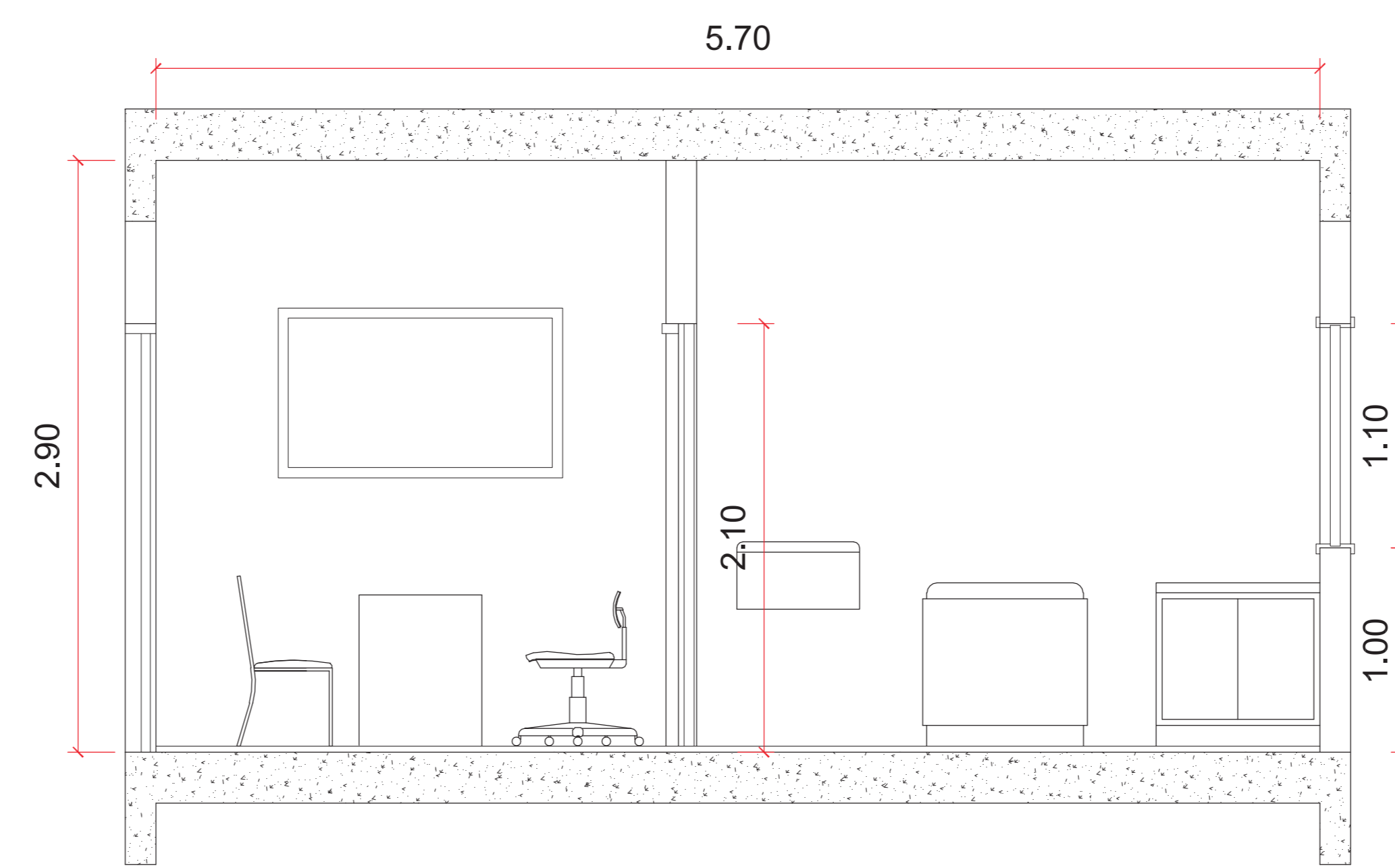

PLANTA BAIXA CONSULTÓRIO-TIPO
ESC: 1/25

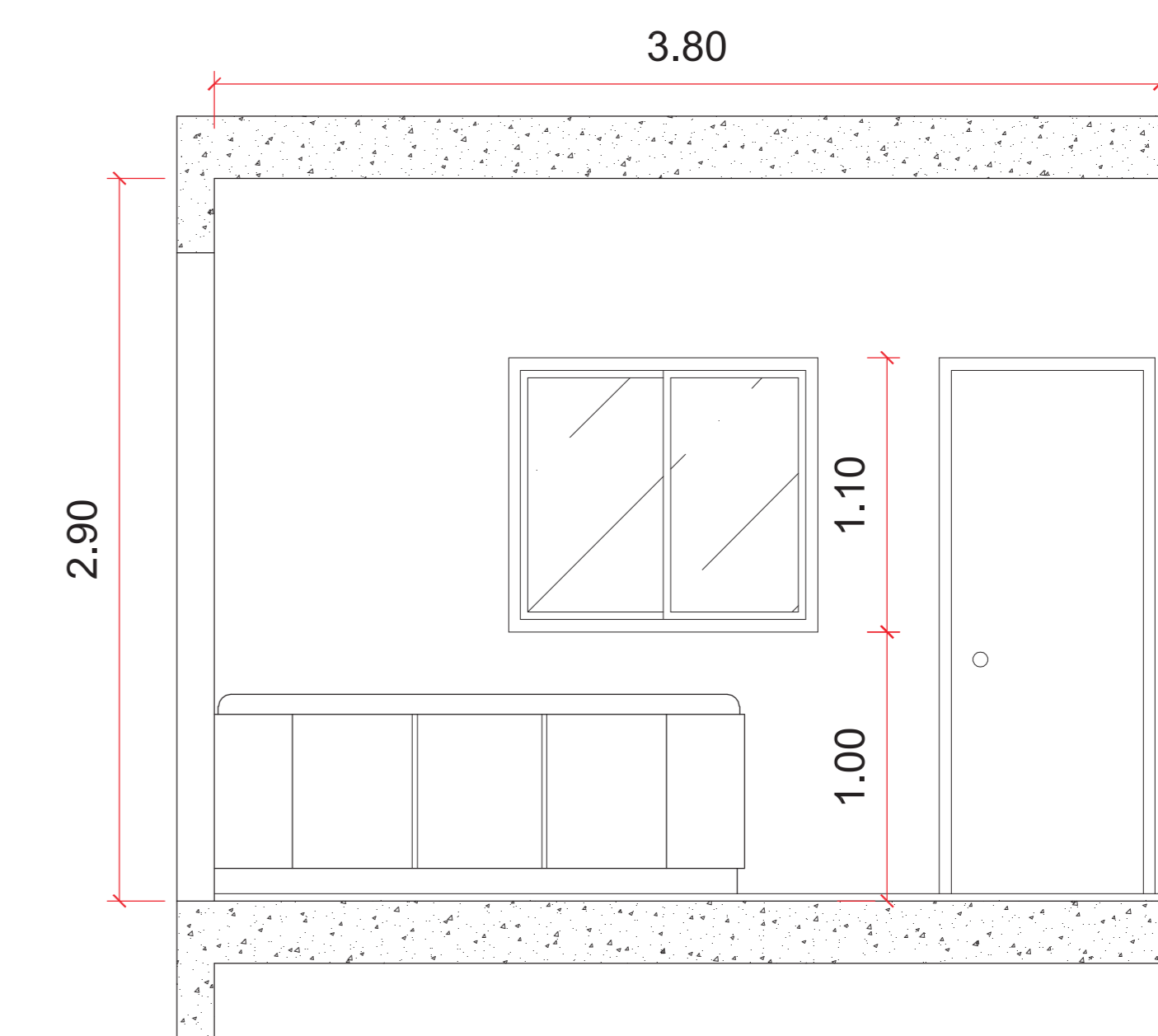

VISTA A
ESC: 1/25



VISTA B
ESC: 1/25

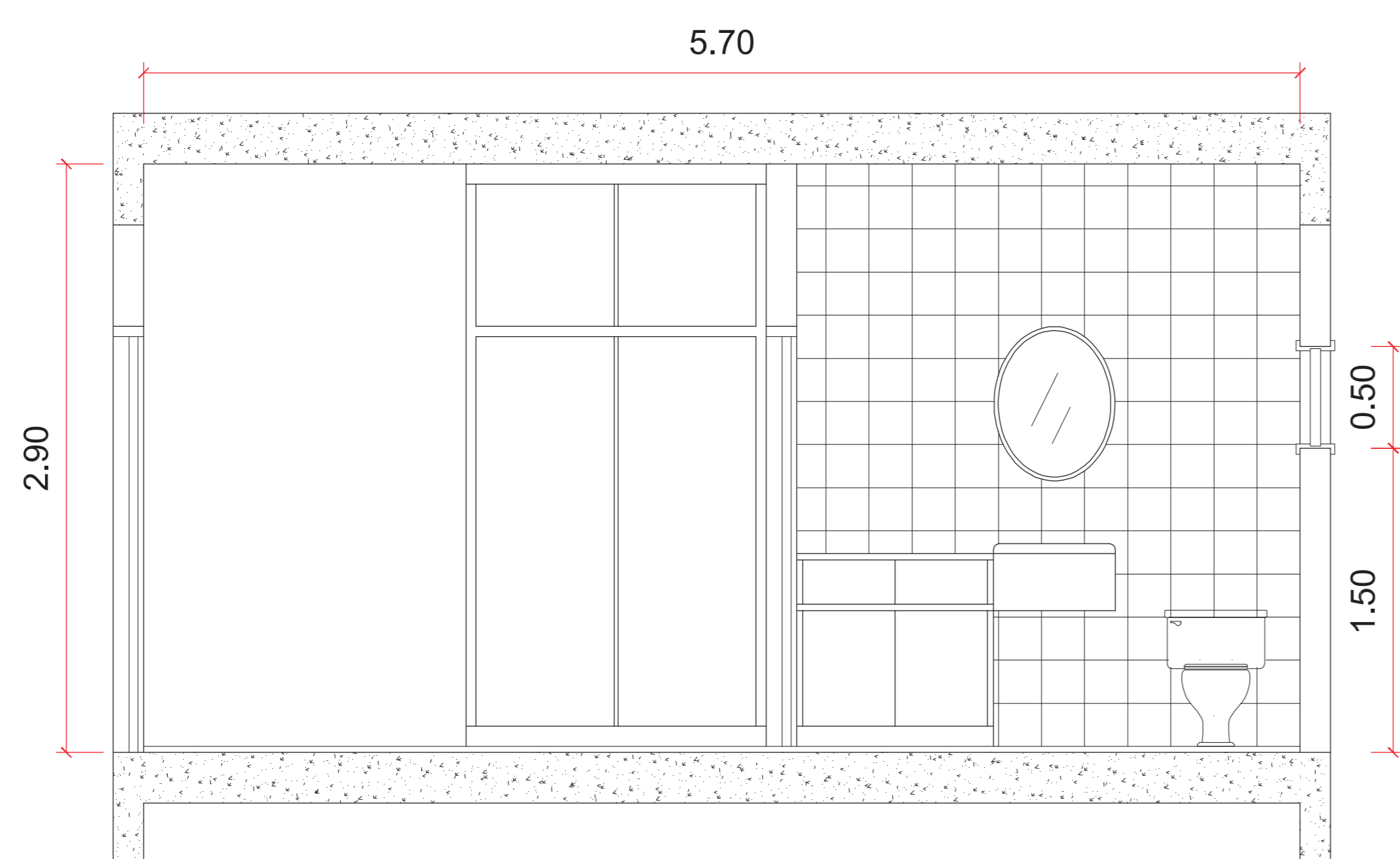

VISTA C
ESC: 1/25

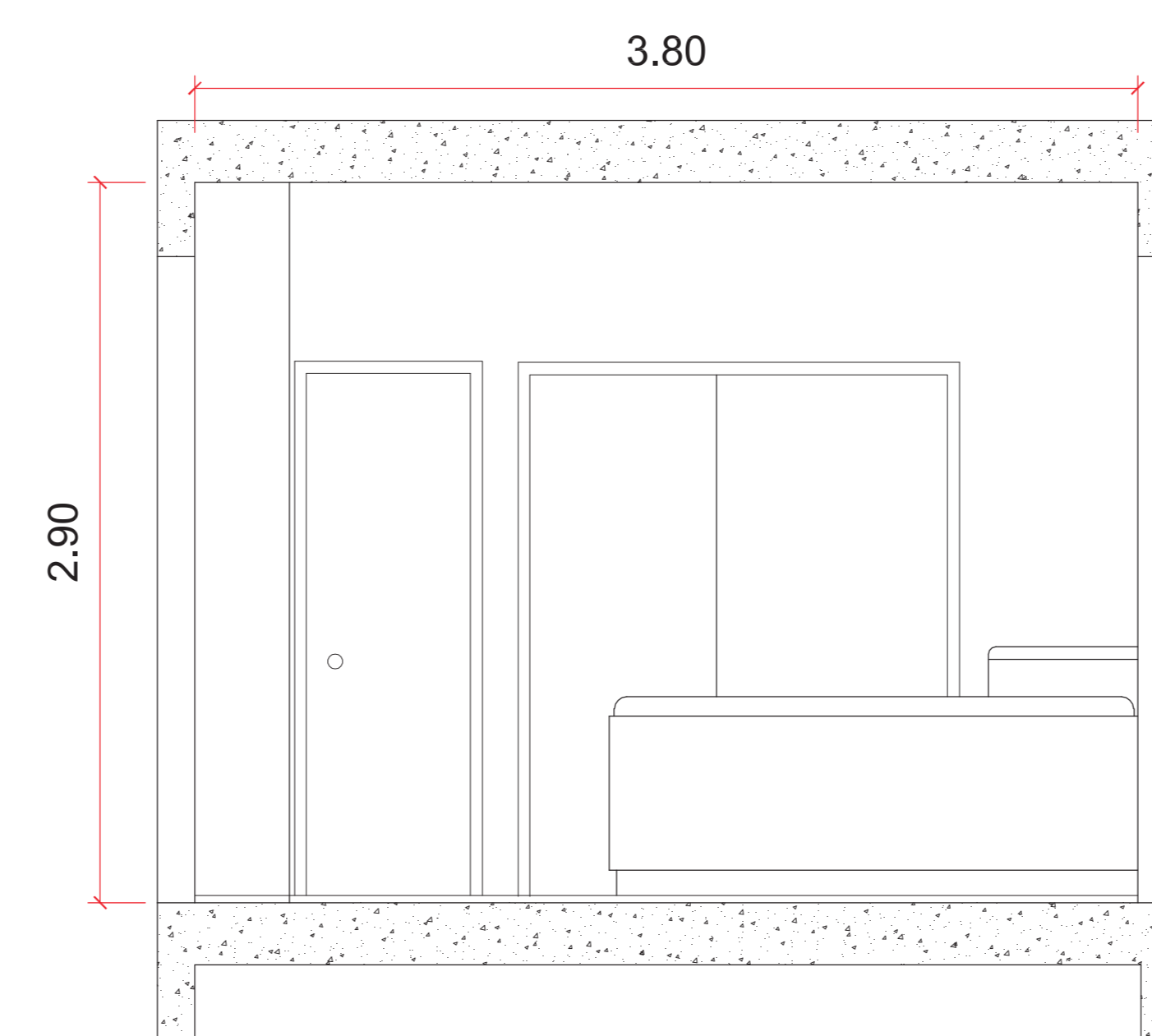

VISTA D
ESC: 1/25



Centro Cardio-Esportivo

Tratamento e prevenção de cardiopatias através do exercício físico

ARQ/UFSC - CTC
Acadêmica: Gianne Souza Kracik
Orientador: Ayrton Portilho Bueno
ARQ5692 - Trabalho de Conclusão de Curso

10/12